



# USER MANUAL

Purewave | 1014 Gateway Blvd | Boynton Beach | Florida 33426  
phone: 561-342-1999 | email: info@purewavelife.com | web: purewavelife.com

PureWave has taken care in preparation of this manual, but makes no expressed or implied warranty of any kind and assumes no responsibility for errors or omissions.

All rights reserved. No part of this manual may be reproduced, in any form or by any means (electronic, mechanical, or otherwise) without the prior written permission of PureWave.

## Contents

<b>Notes</b>	<b>3-4</b>
<b>1. Introduction</b>	<b>5</b>
1.1 Intended use	5
1.2 Description of the buttons	6
1.3 Description of the display	6
<b>2. Start of Operation</b>	<b>7</b>
2.1 Transport and assembly	7
2.2 Power supply	7
2.2.1 AC fuse	7
2.3 Connecting the applicator	8
2.4 Turning on the device	8
<b>3. Functional Characteristics</b>	<b>9</b>
3.1 Basic functions	9
3.1.1 Selecting the applicator jack	9
3.1.2 Turning the display light on/off	10
3.1.3 Turning the speaker on/off	11
3.1.4 Setting the time	12
3.1.5 Setting the language	13
3.1.6 Restore basic settings	14
3.2 Therapy functions	15
3.2.1 Fine tuning of intensity and therapy duration	16
3.3 Timer mode	17-18
<b>4. Applicators</b>	<b>19</b>
4.1 The coil Target Pad	19
4.1.1 Dosage guidelines for the pillow applicator	20
4.2 The Full Body Mat and Target Pad/Pillow Settings	20
4.3 PEMI Owner Login	20
<b>5. The PureWave Magnetic field therapy</b>	<b>21</b>
5.1 Memory of Discomfort in the body	21
5.2.1 Three Programs: Tranquility, Stability, and Vitality	21
<b>6. Troubleshooting</b>	<b>22</b>
6.1 Error messages on the display	22
6.1.1 Error codes during timer therapy	22
6.2 Further error situations	23
6.3 Further error situations	23
<b>7. Maintenance</b>	<b>24</b>
7.1 Safety controls	24
7.1.1 Statutory requirements and regulations	24
7.1.2 Performance of safety checks	24
7.2 Cleaning, disinfection and care	24
<b>8. Contraindications and safety precautions</b>	<b>25</b>
8.1 Operating staff security	25
8.2 Application for baby and child	25
8.3 Further additional reactions in the application	25
8.4 Explanation of the signs used	26
<b>9. Technical data</b>	<b>26</b>
<b>10. Index</b>	<b>26</b>

## Notes

PureWave PEMI is an AC-powered magnetic field therapy device. The device conforms to the CE Norm and is labeled accordingly with the CE sign.

The manufacturer is only responsible for the safety, operational reliability and functionality of the device if:

- the device is used in accordance with the operating instructions;
- the electrical installation of the location where the device will be used meets the respective current requirements of electrical safety;
- the device is not used in hazardous environments and humid locations;
- mountings, enhancements, re-adjustments, modifications or repair works are carried out only by personnel authorized by the manufacturer;

Technical support may be obtained through the manufacturer, dealers or service organizations authorized by the manufacturer. The product's duration of life as scheduled by the manufacturer is 7 years. The PureWave PEMI is an electronic device. Follow your country's disposal regulations in accordance for electronic devices.

### Comments on electromagnetic compatibility (EMC)

Medical, electrical devices are subject to special precautions concerning the EMC. They must be installed and operated according to the EMC-advice given in the accompanying documents. In particular medical and electrical devices may be influenced by portable and mobile RF-communication devices.

The manufacturer guarantees the conformity of the unit with the EMC-requirements only when using accessories which are listed in the EC declaration of conformity. The usage of other accessories may cause an increased emission of electromagnetic disturbances or may lead to a reduced electromagnetic immunity.

The unit must not be arranged physically close to other devices or stacked with other devices. If such an order is necessary, the unit must be observed in order to check if the device operates as intended. You find more EMC-comments in the chapter "Warnings and Safety Precautions" of this manual as well as in the Technical Information on the next two pages.

In accordance with the EMC-regulations for medical products we are obliged by law to provide the following information.

### Guidance and manufacturer's declaration – electromagnetic emissions

The equipment is intended for use in the electromagnetic environment specified below. The customer or the user of the equipment should assure that it is used in such an environment.

Emissions test	Compliance	Electromagnetic environment – guidance
RF emissions, CISPR 11	Group 1	The equipment uses RF energy only for its internal function. Therefore, its RF emissions are very low and are not likely to cause any interference in nearby electronic equipment
RF emissions, CISPR 11	Class B	The equipment is suitable for use in all establishments, including domestic. Those directly connected to the public low-voltage power supply network with Voltage fluctuation/flicker emissions.
Harmonic emissions, IEC 61000-3-2 (*)	Class A	
Voltage fluctuation/flicker emissions, IEC 61000-3-3 (*)	Complies	

(\*) Note: For devices with a power consumption between 75 W and 1000 W only.

### Guidance and manufacturer's declaration – electromagnetic immunity

The equipment is intended for use in the electromagnetic environment specified below. The customer or the user of the equipment should assure that it is used in such an environment.

Immunity test	IEC 60601 – test level	Compliance level	Electromagnetic environment – guidance
Electrostatic discharge (ESD), IEC61000-4-2	±8 kV contact discharge ±15 kV air discharge	± 8 kV contact discharge ±15 kV air discharge	Floors should be wood, concrete or ceramic tile. If floors are covered with synthetic material, the relative humidity should be at least 30%.
Electrical fast transient/burst, IEC 61000-4-4	±2 kV for power supply lines ±1 kV for input/output lines	±2 kV for power supply lines ±1 kV for input/output lines	Main power source quality should be that of a typical commercial or hospital environment.
Surge, IEC 61000-4-5	±1 kV outer conductor - outer conductor ±2 kV outer conductor - ground	±1 kV outer conductor - outer conductor ±2 kV outer conductor - ground	Main power source quality should be that of a typical commercial or hospital environment.
Voltage dips, short interruptions and voltage variations on power supply input lines, IEC 61000-4-11	0% Ut for ½ cycle in 45° steps (100% dip) 0% Ut for 1 cycle (100% dip) 70% Ut for 25 or 30 cycle at 50 or 60 Hz (30% dip) 0% Ut for 250 or 300 cycle at 50 or 60 Hz (100% dip)	0% Ut for ½ cycle in 45° steps (100% dip) 0% Ut for 1 cycle (100% dip) 70% Ut for 25 or 30 cycle at 50 or 60 Hz (30% dip) 0% Ut for 250 or 300 cycle at 50 or 60 Hz (100% dip)	Main power source quality should be that of a typical commercial or hospital environment. If the user of the equipment requires continued operation during power AC interruptions, it is recommended that the equipment be powered from an uninterruptible power supply or a battery.

Note: Ut is the a.c. Main power source voltage prior to application of the test level.

## Notes

### Guidance and manufacturer’s declaration – electromagnetic immunity

The equipment is intended for use in the electromagnetic environment specified below. The customer or the user of the equipment should assure that it is used in such an environment.

Immunity test	IEC 60601 – test level	Compliance level	Electromagnetic environment – guidance
			Portable and mobile RF communications equipment should be used no closer to any part of the equipment, including cables, than the recommended separation distance calculated from the equation applicable to the frequency of the transmitter. Recommended separation distance:
Conducted RF, IEC 61000-4-6	3 V <sub>eff</sub> 150 kHz to 80 MHz	3 V <sub>eff</sub>	$d=1.2\sqrt{P}$
Radiated RF, IEC 61000-4-3	3 V/m 80 MHz to 2.7 GHz	3 V/m	$d=1.2\sqrt{P}$ for 80 MHz to 800 MHz $d=2.3\sqrt{P}$ for 800 MHz to 2.5 GHz
			Where P is the maximum output power rating of the transmitter in watts according to the transmitter manufacturer and d is the recommended separation distance in meters (m). Interference may occur in the vicinity of equipment marked with the following symbol: 

# 1. Introduction

## 1.1 Intended use

The PureWave PEMI System is the result of more than 20 years of fundamental research by leading international scientists. A qualitative breakthrough has been achieved with this system in the domain of magnetic field therapy, by basing this therapy on a sound scientific foundation, which will ensure its place in the Health and Wellness Field.

The PureWave PEMI System serves as an Energy therapy and has proven successful in many indications. It supports both cell revitalization and cell metabolism by targeted ion transport of Cells. The whole metabolism is activated, the immune system stabilized and cell regeneration improved, thereby strengthening weakened body functions in a natural way.

Through the applicators, the control unit creates a low frequency, variable, vibrant magnetic field of the body's frequency pattern mimicking the body's precisely defined electromagnetic waveform frequencies and electromagnetic waveform shape. The intensities of these frequencies are adapted according to the vital parameters and specifics to the biological frame of the cell structures that are to be applied as indicated.

Since the individual electromagnetic hypersensitivity varies depending on a person's health and blood's acidity, the magnetic field intensity may be altered to achieve the ideal effect. The magnetic field intensity must be explicitly chosen by the user. The PureWave PEMI works with field strengths up to 40 micro Tesla and therefore well below the WHO limit and the so-called geomagnetic earth radiation.

For comparison:

Highest PureWave PEMI intensity	40 $\mu$ T
Terrestrial magnetic field	50 $\mu$ T
WHO limit	100 $\mu$ T

On this scale, the therapy's intensity may be adapted to a person's current state of health manually.

The treatment time can be perfectly adapted to each person's individual needs. After an individually set time (1-60 minutes) the control unit automatically switches the magnetic field off.

The positive physiological effects which are set in motion through the use of the PureWave PEMI magnetic field and frequency waveforms, usually take place within 8 hours (healthy organism). Recommended therapy application is in the morning, midday and evening.

The PureWave PEMI System is a "Home Device". With this device it is possible to carry out electromagnetic therapies with the Tranquility, Stability, Vitality programs from the comfort of your own home.

### 1.2. Description of the buttons

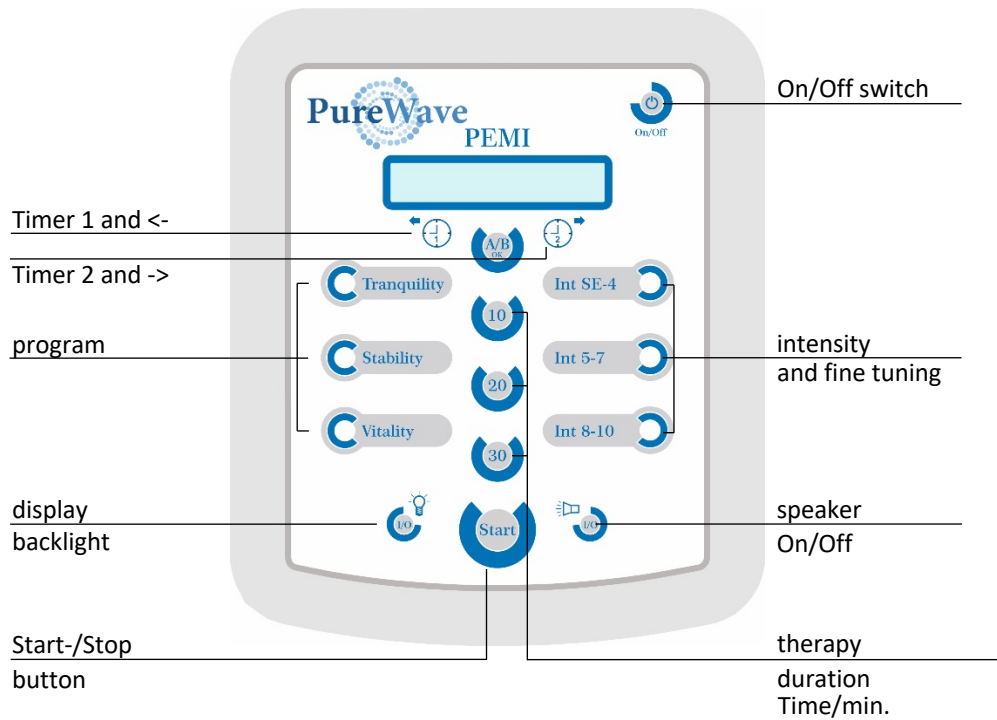

### 1.3. Description of the display

The PureWave PEMI system has a 16-digit display. The content depends on the current device function. For detailed information please refer to chapter 3, Functional characteristics.

Example:



Military Time, selected therapy program

## 2. Start of operation

### 2.1. Transport and assembly

The image below shows the power inlet and fuse receptacle on the device's rear side.

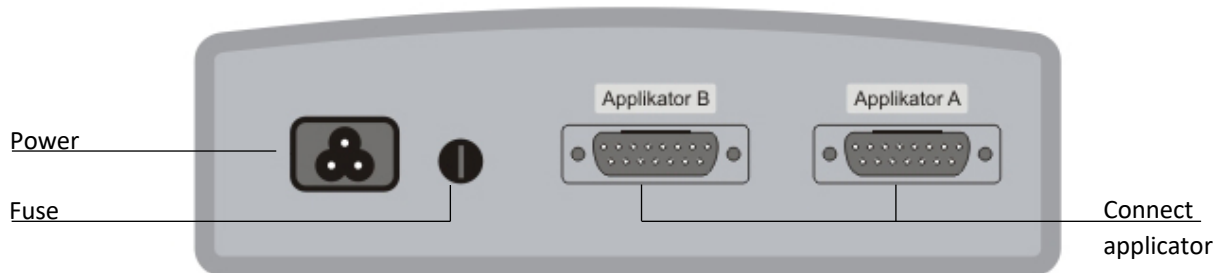

As a powered appliance, the PureWave PEMI should not be moved during the running operation. Any location on a level surface is suitable. The device should not be placed in front of a heater or radiator (leave approx. 1 m clearance). There are no further requirements concerning wall distance or ventilation. The device meets the requirements DIN/VDE 0750, EN 60601-1, EN 60601-1-2.

#### ATTENTION

The unit is not designed to be operated in places with the inherent risk of explosions. If it is used in dangerous areas, such as; anesthesia departments, the possibility of an explosion cannot be excluded.

#### ATTENTION

In order to prevent the risk of electric shock, the unit must be connected only to an AC power supply network with protective ground conductors.

As a rule, a distance of 3 m is sufficient for being exposed to a heat radiator or high frequency heat therapy. Damage to the device or person is possible if exposed to these items.

### 2.2. Power supply

The PureWave PEMI system is intended to be connected to main power source voltages of 115 V or 230 V and the frequencies of 50 or 60 Hz. Within this range there is no need for further change or alteration on the devices. Connect the device's power socket to a grounded socket by means of the included power cord.

#### NOTE

The PureWave PEMI system allows time-controlled operation (Timer Mode/Auto Clock). In this case the device starts automatically at a predefined time, selected via button programming (see 3.4, Timer Mode). The system remembers the last program settings used, even if it has been turned off via the on/off switch. It will remember the settings for up to 30 days if unplugged. We recommend keeping your main power cord plugged in at all times. Never connect the device to a power strip or surge protector.

#### 2.2.1 Main Power Source fuse

The Main Power Source fuse serves to protect the device from further damage in case of a serious error. The Main Power Source fuse is not subject to aging or wear. If the device does not power on, make sure that the fuse socket and main power cord on the back side of control housing, are plugged in properly. If this is not the problem, please check the fuse and replace it with a new fuse with the same type and value.

The AC fuse is located in the fuse carrier on the back of the device as shown in the image above. The fuse is accessible by gently pressing the fuse carrier toward the device and turning it about 1/8<sup>th</sup> turn counterclockwise.

**ATTENTION**

Please contact an authorized service partner in case of doubt after a failed/blown fuse or after multiple failures of a blown fuse have occurred.

### 2.3. Connecting the applicator

Please connect 1x or 2x of the applicator(s) (pillow, mat, pen, goggle, headphones) to the 15-pole jack(s) on the back of control housing (submin-D).

**ATTENTION**

The applicator's 15-pole jacks are provided with 2 thumb screws for attachment. It's **best to plug in applicators without tightening screws**. Never apply tools to the attachments.

### 2.4. Turning on the device

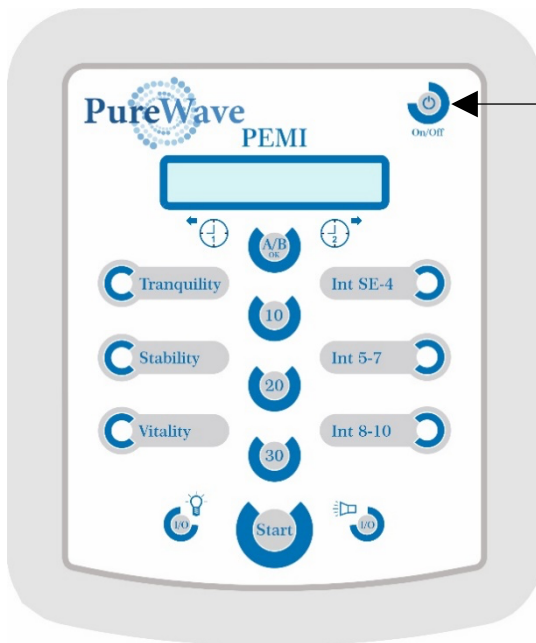

To switch on the device please press the On/Off button.

The display shows the following text

PureWave V1.5

V1.5 is the current software version's label and may change during the device's development cycle.

The device now performs an automatic function test.

SYSTEMCHECK

In case of grave errors the display shows an error code (see chapter 6, Troubleshooting).

If everything works properly, the display will show

SYSTEM OK

If required please adapt application-specific settings (see chapter 3.1).

The device is now ready for operation, it displays the last operating state/settings, and waits for your input (select new settings or just press START to run previous run settings).

**NOTE**

Purewave PEMI comes with a time-out, turning the device off 8 minutes after not having been used (8 minutes after the end of therapy or 8 minutes after the last button-click). After this shutdown, the device has to be restarted as described above.



### 3. Functional Characteristics

#### 3.1. Basic functions

##### 3.1.1 Selecting the applicator jack

Purewave PEMI is equipped with jacks for two applicators (see image in chapter 2, Start of operation). The physical identification for those two jacks are “A” and “B”. If two applicators are connected, select which applicator to use by pressing the A/B Button. **Only one applicator can run at a time.**

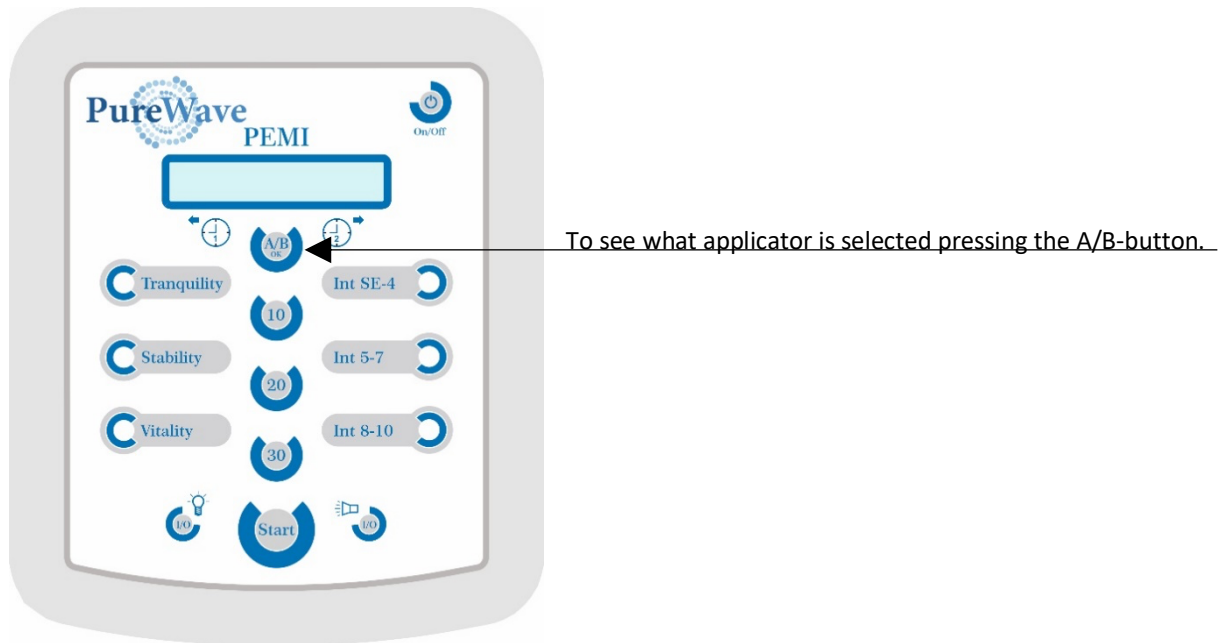

The LCD Screen shows by name which applicator is selected.

You may for example see the following display:

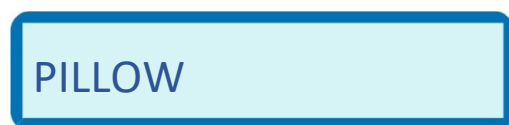

This display will be shown for 1.5 seconds before returning to the display of the operating mode.

You may switch to the respective other applicator by pressing the A/B-OK-button a second time while the above stated display is still visible and it will display the other connected applicator to run.

<b>NOTE</b>	You may only switch to another applicator if two applicators are actually connected to the device. If only one applicator has been connected, it will be the only applicator shown in the display.
-------------	--

### 3.1.2 Turning the display light on/off

The display's backlight may be turned on or off. If it is turned on, it stays active during the whole operation. If it is turned off, the display will light up for every button push operation, but shuts off independently after one minute.

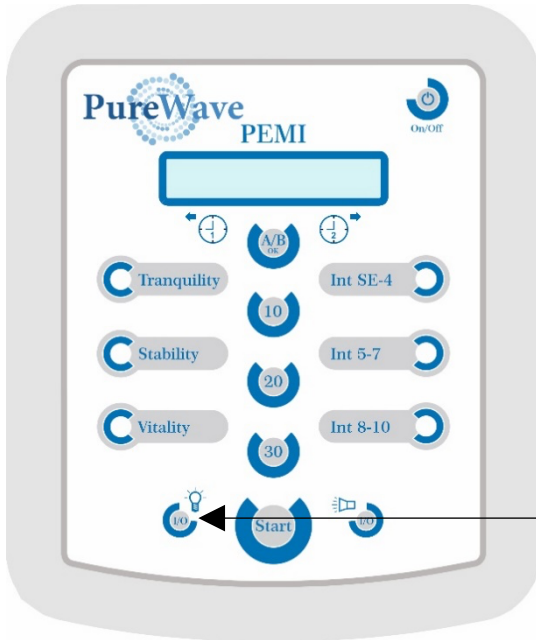

The backlight status may be checked by simply pressing the I/O-button.

Depending on its status one of the following displays will appear:



or



<b>NOTE</b>	These are always visible for 1.5 seconds before returning to the previous status. If the I/O-button is being pressed while the display shown above is visible, the display light's status will be changed, i.e. the switched on display light will be turned off and vice versa.
-------------	--

### 3.1.3 Turning the speaker on/off

The PureWave PEMI contains a speaker, called beeper from now on. This beeper signalizes a button-click, an error or the end of therapy with different sounds, each. The button-clicks acoustical echo sound, as well as the error signal sound, may not be turned off, however, the acoustic signal sound at the end of a therapy session, can be turned ON or OFF, since the “End of Session Sound” could disturb some people.

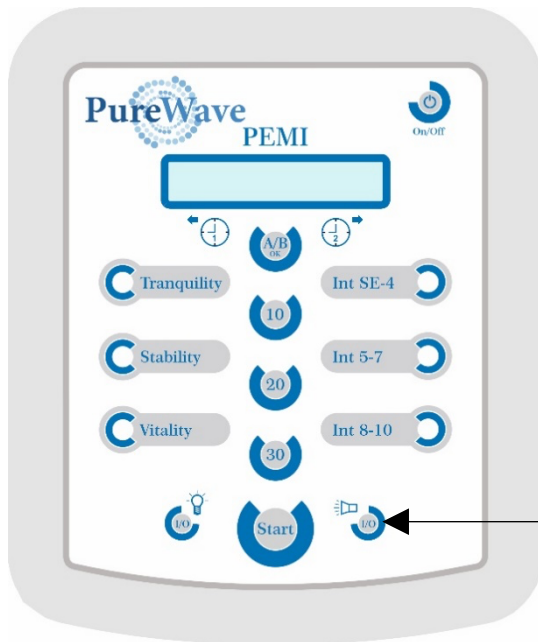

The end of therapy’s signal status may be checked by simply pressing the I/O-button.

Depending on its status, one of the following displays will appear:

TH.-END BEEP ON

or

TH.-END BEEP OFF

**NOTE**

These are always visible for 1.5 seconds before returning to the previous status. If the I/O-button is being pressed while the display shown above is visible, the end of therapy signal’s status will be changed, i.e. the switched-on signal will be turned off and vice versa.

### 3.1.4 Setting the time and date

The PureWave PEMI displays a military clock on the left corner of LCD Screen (battery backed RTC). To set the time, the device's user interface offers you convenient menu guidance.

**NOTE** Turn off the device to begin setting Time and Date.

You may reach the corresponding; "SET TIME/DATE" by Shutting off the Unit via the ON/OFF-button shown.

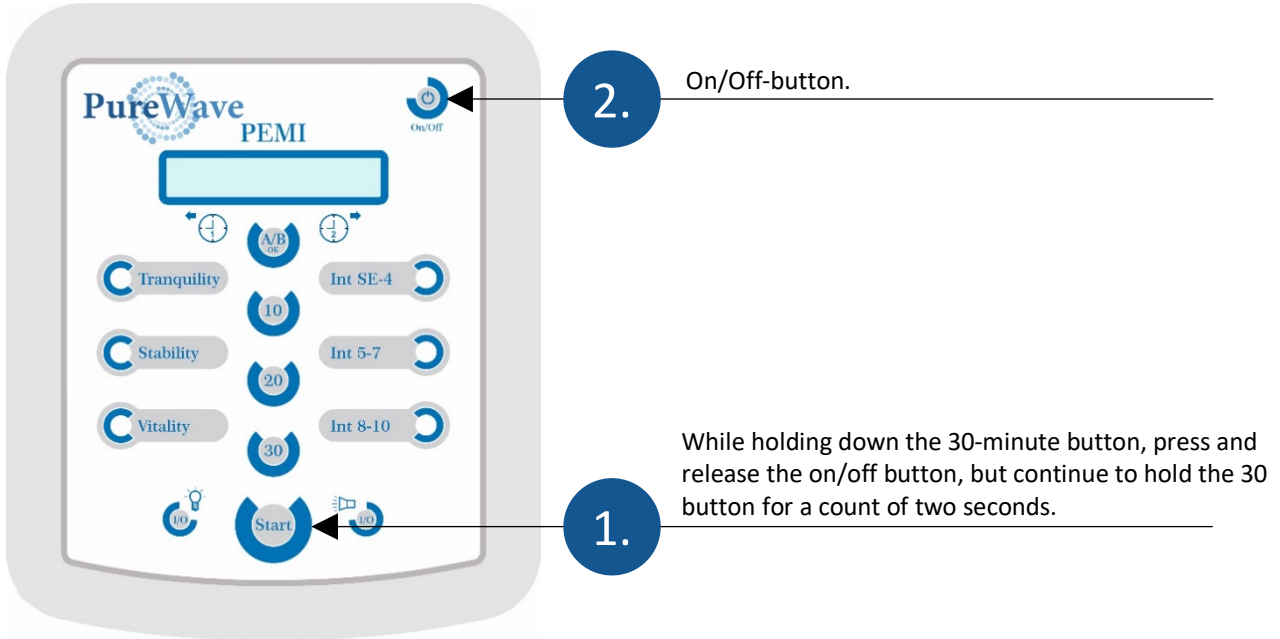

You are now in the menu to set the time and see the display (exemplary time)



The blinking cursor is positioned on the time's first digit, "1", as shown above. You may now change the time by increasing the digit by clicking the right arrow-button, or to lessen the digit, click the left arrow-button.

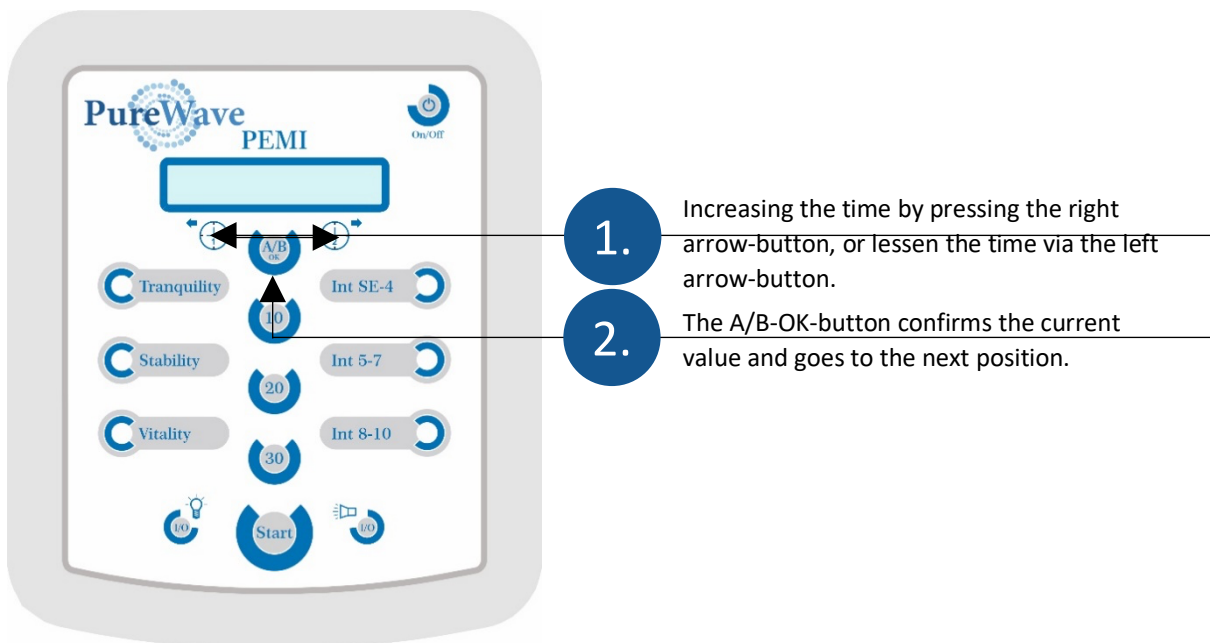

After confirming the last time digit, you automatically reach the menu to set the date. The corresponding display may look as follows:

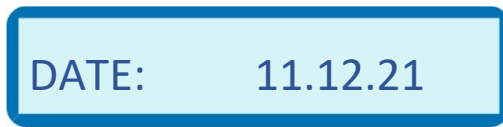

Please proceed accordingly to set the date (European Format). By confirming the last date digit, the menu is closed and the device will be started with its standard functionality.

**NOTE**

You may leave the menu to set time and date at any time by pressing the Start-Stop-button.

### 3.1.5 Setting the language

You may operate the PureWave PEMI in different languages. To set the standard language the device's user interface offers you convenient menu guidance.

**NOTE**

Turn the device off before you start.

You may reach the corresponding menu by

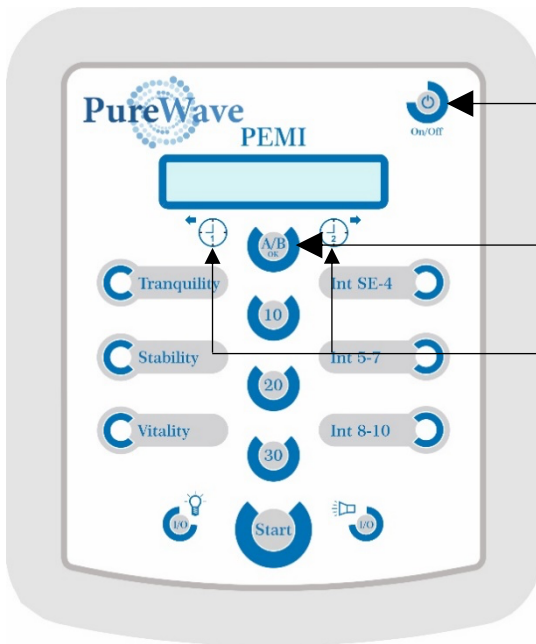
**2.**

On/Off-button

**1.**

While holding down the A/B- button, press and release the on/off button, but continue to hold the A/B button for a count

**3.**

You may press the left or right arrow-button to choose among various languages.

You are now in the menu to set the language.



The abbreviation of the currently selected language is marked between brackets "[ and ]".

The following languages are available:

[EN] English    [DE] German    [FR] French    [IT] Italian    [ES] Spanish    [SE] Swedish

Pressing the AB/OK-button confirms the current selection, leaves this menu and starts the device and its standard functionality.

**NOTE**

You may leave the menu to set the language at any time by pressing the Start-Stop-button. The currently made (incorrect) setting will not take effect.

### 3.1.6 Restore basic settings

Through a certain hot button you may restore the factory-made basic device settings.

**NOTE** Turn the device off before.

You may restore these basic settings by

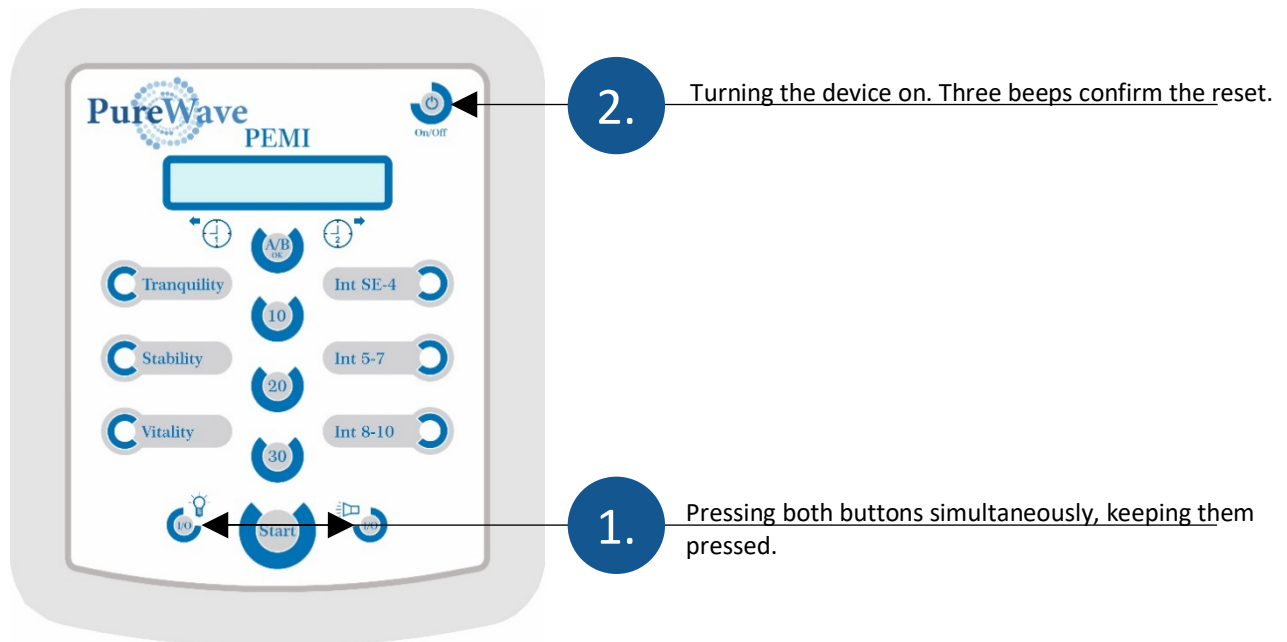

The restored basic settings

- display light      off
- speaker            on
- language            EN (english )
- therapy program tranquility
- therapy intensity medium
- therapy duration 10 min
- timer 1              off and 06:00 o'clock, "Vitality", "medium", 10 min.
- timer 2              off and 22:00 o'clock, "Tranquility", "medium", 10 min.

### 3.2. Therapy functions

The home therapy describes a mode of operation where a PEMI therapy is performed via simple button programming.

The operation is quite simple. For each therapy, three parameters have to be defined:

- the therapy program (Tranquility, Stability or Vitality)
- the therapy intensity (Int SE-4, Int 5-7 or Int 8-10) Can be set to: Sensitive, 1, 2, 3, 4, 5, 6, 7, 8, 9, 10
- the therapy duration (10, 20 or 30 minutes) Can be set to: from 1 to 60 min.

You may select the stated parameters via control buttons on the buttonboard.

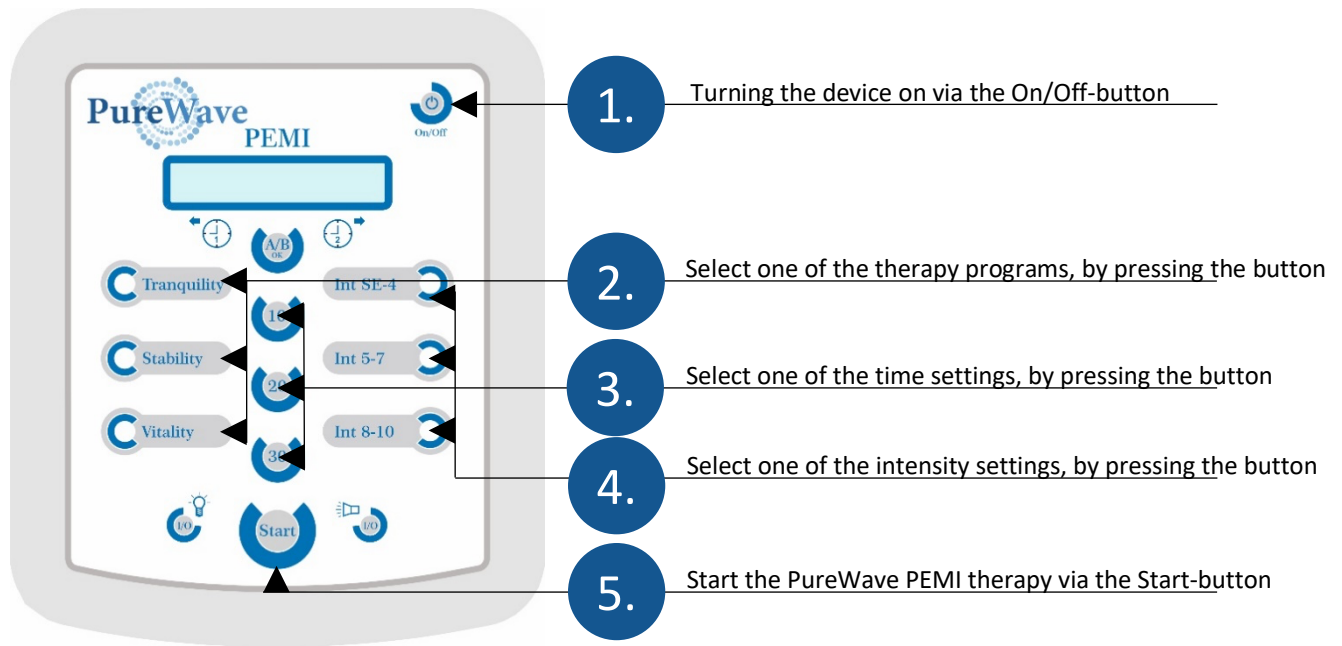

After starting the therapy, the display will change to the following view:

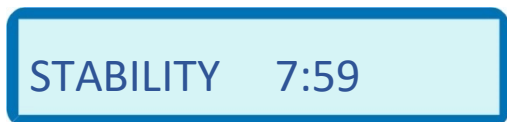

The display on the left side is alternating between the current therapy program and selected therapy intensity.

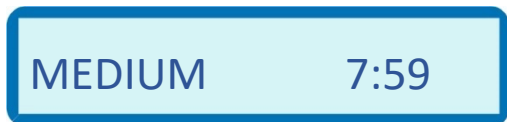

The right side displays the remaining time until the end of therapy.

### 3.2.1 Finetuning of intensity and therapy duration

The intensity and duration of the home-therapy can be fine tuned. TURN ON UNIT then

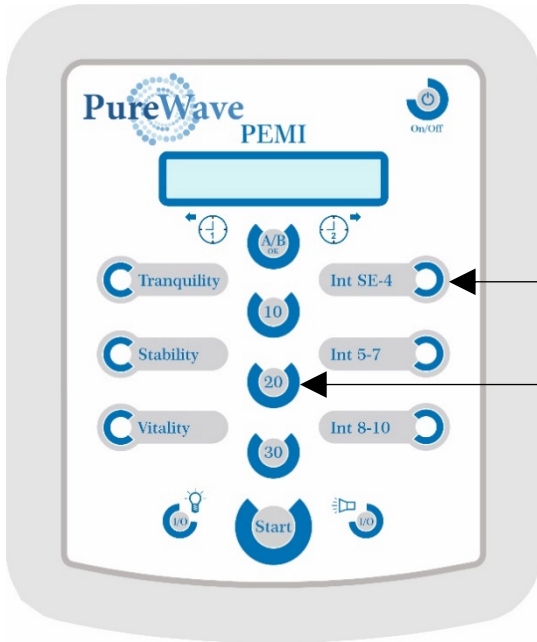

Changing intensity setting:  
press the button for 2 sec. until the time in the display flashes

Changing therapy duration:  
press the button for 2 sec. until the intensity in the display flashes

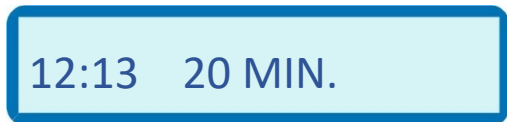

The therapy duration can be adjusted starting from any time button (10 min, 20 min, 30 min). Press one of the time buttons for 2 sec. until the time in the display flashes.

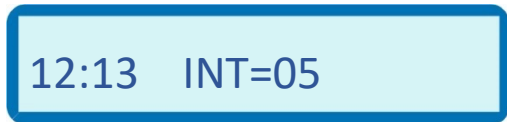

The intensity can be adjusted starting from any of the intensity buttons (Tranquility, Stability, Vitality). Press the button for 2 sec. until the intensity in the display flashes.

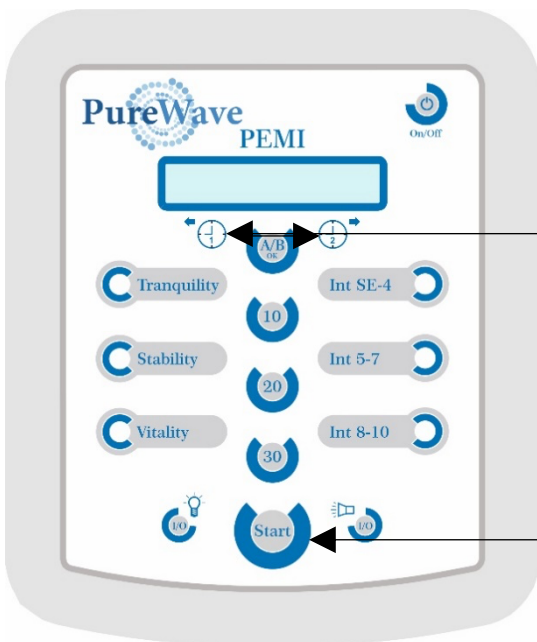

Decreases/increases time and intensity setting:  
By pressing the left arrow button the time decreases in 1 minute steps and by pressing the right arrow button the time increases in 1 minute steps. By pressing the left arrow button the intensity decreases and by pressing the right arrow button the intensity increases. The intensity range starts from „SE“ (=sensitive) up to 1-10.

After having reached the desired setting press the A/B-OK button and continue with normal operation. You can directly start the therapy with pressing this Start button.

**NOTE** The therapy program “Tranquility” allows only values up to 5. The last settings are saved until you set something else.



### 3.3 Timer mode

The PureWave PEMI contains two independent “timers”. These programmable timing circuits serve to **Automatically Start a Full Body (or any selected applicator) Therapy Session at a Set Time of Day or Night.** Here you are free to choose the starting time, duration, and all therapy parameters (therapy program, intensity, duration). The timers have to be programmed and activated. After an Initial programming/activation with a 24 Hour Clock Cycle Needed to turn on the clock settings,....the Timers will Start Automatically and run the selected therapy every 24 hours, unless they have been deactivated with the On/Off selection during programming.

**NOTE** To perform a therapy in timer mode, the device must be turned off and remain connected to a live power supply (see chapter 2.2, Power supply). At the first use of the timers they are set as described in chapter 3.1.6, Restore basic settings.

The following example shows the commands for timer 1. Timer 2 is to be handled identically. Activation and deactivation of both timers begin with a switched-off device.

The diagram shows the PureWave PEMI control panel. Callout 1 points to the left arrow button, stating: "To program the timer 1 please press and hold the left arrow-button." Callout 2 points to the On/Off button, stating: "Now turn the device on via On/Off-button." The panel features a display at the top, an A/B button, and various therapy settings like Tranquility, Stability, Vitality, and intensity levels (Int SE-4, Int 5-7, Int 8-10).

**TIMER 1: [OFF] ...** The display shows the timer is off.

The diagram shows the PureWave PEMI control panel with callouts for activation steps. Callout 1 points to the right arrow button, stating: "To activate the timer apply the right arrow-button, to deactivate the timer apply the left arrow-button." Callout 2 points to the A/B button, stating: "The display will change, accordingly. This command must be confirmed via the A/B-OK-button." The panel features a display at the top, an A/B button, and various therapy settings like Tranquility, Stability, Vitality, and intensity levels (Int SE-4, Int 5-7, Int 8-10).

If the timer is deactivated, the device will now start with the standard operating mode. If the timer is activated you may now start with its programming. As its first programming step you will set the time at which the therapy shall be started automatically. The display will show the following menu (exemplary time):

TIME T1: 22:30

TIME T2: 07:30

To set Timer 1 press and hold the left arrow-button and then press the On/Off-button.

To set Timer 2 press and hold the right arrow-button and then press the On/Off-button.

The blinking cursor is positioned on the time's first digit "2", as shown above.

You may now change the time by increasing the digit positioned below the cursor by pressing the right arrow-button, or to lessen it via the left arrow-button.

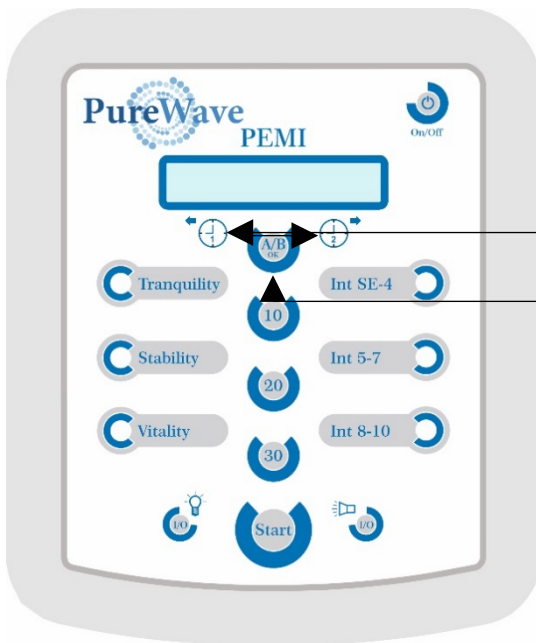

Increasing the digit positioned below the cursor by pressing the right arrow-button, or decrease it via the left arrow-button.

Pressing the A/B-OK-button confirms the current value and goes to the next position.

After confirming the last time digit you automatically reach the menu to set the therapy parameters. If already programmed you can now see the settings chosen for this timer regarding therapy program, therapy intensity, therapy duration and applicator. To change one or several of these settings you may press the corresponding control button in any given order.

Should 2 applicators be connected to the control unit you may also change the respective applicator via A/B-OK-button. After the first click on this button the programmed applicator will be displayed for 1.5 seconds.

The respective applicator will be changed by pressing the A/B-OK-button a second time while the display is still visible – i.e. no later than 1.5 seconds after the first click.

Programming the timer is concluded by pressing the Start-button or the On/Off-button. In both cases all previously set values will be saved for this timer. By pressing the Start-/Stop-button the device will be set to the standard operating mode. The On/Off-button will turn the device off.

**NOTE**

If a PureWave PEMI control unit with activated timer is taken out of the power supply and reconnected later, the device will switch on, independently, display the text „AUTOMODE“

## 4. Applicators

The PureWave PEMI control unit generates through **All of its Applicators, a pulsating electromagnetic Induction field of the body's own Base Frequencies and Harmonics, with Specific Placements and Patterns of over 10,000 Base Frequencies in combinations that precisely define and mimic the body's own waveform. The field strength corresponds to the biological windows of humans.** To achieve an optimal effect, **the electromagnetic field strength was designed to be a variable by adjusting a programmable Intensity, because the electro sensitivity is subject to variations depending on the Tissue Density of the Body and the different areas within the body, as well as; being dependent on the health of the user and the acidity level of their blood.** The field strength or intensity of the magnetic field can be chosen in 3 steps: SE-4, Int 5-7 and Int 8-10.

The control unit automatically switches off after 8 minutes, unless it has been individually programmed from 1 to 60 minutes. Treatment with the PureWave PEMI magnetic field triggers positive effects on the human organism which continue for up to 8-12 hours. To vitalize and stabilize good health in healthy people, we recommend two to three Full Body Sessions per day, about 8 hours apart (Morning "Wake-up" & "Bedtime").

The PureWave system has several applicators at its disposal. These guarantee the most effective therapy results, even with a large variety of different indications.

One of the applicator specific characteristics is the corresponding magnetic flux density, especially regarding the setting of a definite intensity on the control unit. For your information the following table states the magnetic flux density in micro Tesla ( $\mu\text{T}$ ) – measured directly at the applicator ( $\pm 10\%$  tolerance) – for the three most common applicators.

Level	Mat ( $\mu\text{T}$ )	Target Pad/Pillow	Pen
sensitive	0,3	0,4	0,15
1	3	4	1,5
2	6	8	3
3	9	12	4,5
4	12	16	6
5 medium	15	20	7,5
6	18	24	9
7	21	28	10,5
8	24	32	12
9	27	36	13,5
10 intensive	30	40	15

### NOTE

During therapy the appliance ensures that electro-smog cannot pollute the body and therefore degrade the therapy. 50-60 Hz EMF (electro-smog has been eliminated)

### 4.1. The coil Target Pad/Pillow

The Target Pad/Pillow is applied purposefully for individual parts of the body.

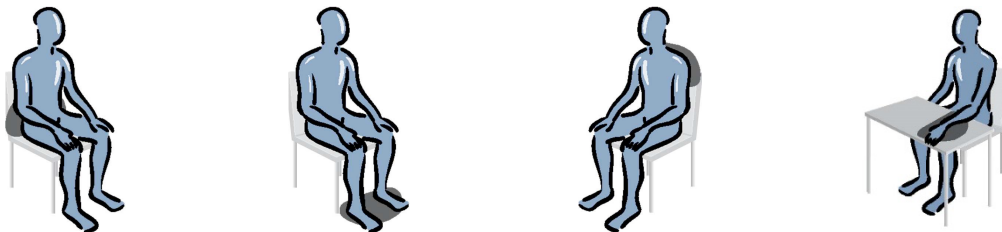

### ATTENTION

The magnetic field effectively spreads up to 0.3 meters sideways and up to 1.2 meters vertically, which means that people in the immediate proximity during treatment will receive a gentle stimulation.

### 4.1.1 Initial Dosage guidelines for the pillow applicator

The PEMI targets specific areas of the body. Specific Target Intensities (SE to #10) and guidelines can be found in the online Resource Portal for PEMI owners. Go to our website [www.Purewavelife.com](http://www.Purewavelife.com). Scroll to the bottom of the home page and click on PEMI Owner Login and then enter password. Or you can scan the QR Code below.

### 4.2 The Full Body Mat and Target Pad/Pillow Settings

Scan QR Code to go to PEMI Owner Resource Portal or go to our website [www.Purewavelife.com](http://www.Purewavelife.com). Scroll to the bottom of the home page and click on PEMI Owner Login and then enter password.

### 4.3 PEMI Owner Login

Below is the QR code that directly takes you to our PEMI Owner Resource Portal, where you will find supporting material on how to best work with your PEMI.



## 5. The PureWave PEMI magnetic field therapy

Provisions for the ideal impact of the PureWave PEMI therapy are:

- to drink sufficiently: 1 glass of water before and after each application can help further improvement.
- support through vitamins, minerals, trace elements (mainly magnesia/magnesium).
- regular, sensible and balanced nutrition.
- refrain from radical diets.
- no abrupt discontinuation of medication.
- regular application of the PureWave therapy.
- start PureWave therapy at low intensity, increasing slowly.

Information regarding the magnetic field strength settings is given in the preceding chapter. Session times: Possible treatments per day: 3 times (morning, midday and evening). After 6 PM the setting of the “Stability” Program should not be higher than setting medium. Use the “Tranquility” Program to experience positive influence on sleep.

Therapy Total duration per day: Up to 2 hours is comfortable for full body or small areas using Concentrator Applicators. Concentrator Applicators can be run on the same body location for maximum 30 min. each session, up to 4x sessions maximum per day with 4x hours OFF after each session to the same area of the body... (“not running the same session on the same location for at least 4x hours”).

The general rule of use is to Run Applicators only “Twice per Day” on the “Same Area of the Body”, as the positive effects should last up to 8-12 hours in that area of the body receiving the therapy. If extra applications are needed, follow the 4x hour break/Off Time in-between each session to the same area.

## 5.1 The Pain Memory of the Body

The Body's learned pain memory works in steps, up and down. After every improvement from any modality being applied that helps with severe discomfort, a discomfort level can start again, and it should become less and less with each session (cumulative outcome builds) until the discomfort level is brought down to 0 %.

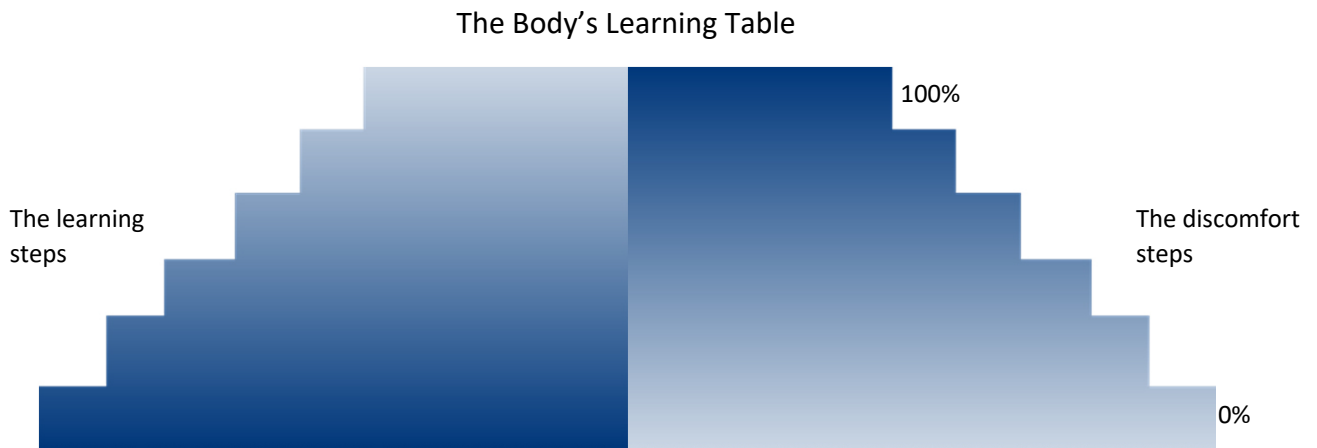

## 5.2 Three PEMI programs:

Tranquility, Stability, Vitality

Experience with the reliable PureWave Electromagnetic Waveform signal frequencies, has led to the PureWave PEMI magnetic field therapy device to include 3 programs, with intensities selectable from Sensitive (Sen) to Intensive. The following programs can be chosen:

### 5.2.1 The Stability-program

The Stability-program is the traditional and effective PureWave PEMI-program that is most effective in amplifying targeted Intensity effectiveness and outcomes using any of the concentrator applicators for local, targeted applications of the body, or choosing the full body mat for slower, steady, whole body targeting effectiveness. Stability is selected and applied via Selection Advice recommendations. It covers the Base Frequencies Spectrum from 0.1 Hz to over 10,000 Hz. This program is transporting ions, especially protons. Harmonic frequencies propel out to create over 100,000 Harmonic Frequencies per second in specific patterns and varying combinations to attend to every cell type in the body, by mimicking the body's own frequency waveforms.

“As experiments have shown, basically every biological organism can benefit, especially organisms with a blood- or lymph-circulation. This device is recommended for using on humans and pets in the home, medical, and sports, including Health & Wellness facilities.”

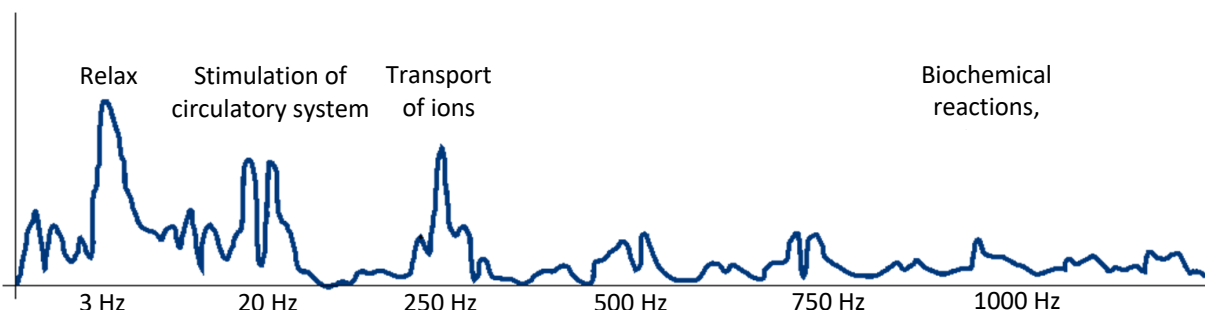

### 5.2.2 The Tranquility-program

Fields of Application: Relaxation, Immune, Promotion of Sleep. To achieve these effects, special frequencies for the circulatory system were reinforced in the Tranquility-program, compared to the Stability-program. It can be used with the settings from: SENSITIVE (SE) to INTENSIVE (INT 5) . HIGHER intensities above INT 5 are not sensible for a RELAXED TRANQUILITY setting and therefore blocked.

5.2.3 The Vitality-program. Indications: Increase of VITALITY and ATTENTION (EXCELLENT for elderly people), and good for people with sensitivity to weather changes.

## 6. Troubleshooting

The PureWave system may recognize error situations on its own and show the corresponding messages on the display. Some of these errors may be corrected by the user, without outside help. The following description classifies errors roughly as those which may be shown on display with a comprehensive message and others which may not be described, if only incomprehensibly.

For all errors the symptoms – and if possible – also the cause and the remedy are described.

### ATTENTION

In case of any doubt please contact the manufacturer, an authorized service partner or your distributor! For all actions reaching beyond the measures as described in chapters 2 and 3 the AC cord has to be removed from the socket or the device's jack!

### 6.1 Error messages on the display

**CONNECT APPLIC.!**

No applicator has been connected or applicator connector is loose.

➔ Please connect an applicator.

**APPLIC.DEFECITVE**

The applicator does not conduct current. The applicator or its connection cable may be damaged, usually caused by rough or improper handling.

➔ Please check if the applicator has been connected and tightened correctly. If available test another applicator on the device's corresponding connection. In case of visible (mechanical) damages, please contact your service partner or distributor.

**ERRORCODE: NN**

The control unit has detected an error during its self-test.

➔ Turn the control unit off and back on after a few seconds. If this is a permanent or recurring error, please contact your service partner. Please note the error code >>nn<< and forward it to your service partner!

## 6.2 Error codes during timer therapy

If a timer therapy (activated by the user via timer programming) could not be performed a fault report will appear on the display the next time the device is started. This report must be acknowledged by pressing the Start/Stop-button TO RESET. For each possible time-controlled therapy – timer 1 and timer 2– the display will show the following messages:

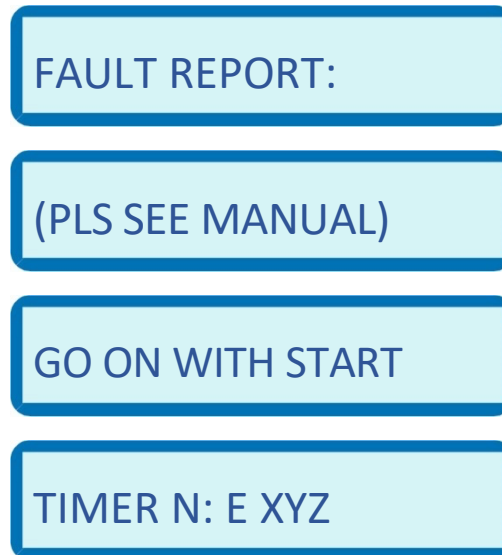

In the last stated message the >>N<<states the number of the timer or therapy, >>xyz<< represents an error code, meaning the following:

- E101 No applicator has been connected.  
 ➔ Please connect an applicator respectively the one prescribed on the chip card.
- E102 The applicator does not conduct current. The applicator or its connection cable may be defect, usually caused by rough or improper handling.  
 ➔ Please check if the applicator has been connected and tightened correctly. If available test another applicator on the device's corresponding connection. In case of visible (mechanical) defects please contact your service partner or distributor.
- E103 The therapy could not be started since the device was already in operation.  
 ➔ Please check the starting times, correct them, if required and repeat the therapy, if necessary.
- E104 The therapy could not be started due to an error within the device (communication problem).  
 ➔ Please contact your service partner.

## 6.3 Further error situations

Symptom	Cause / Remedy
The device cannot be turned on, the display stays dark and empty	Please check if the socket and AC cord conducts line voltage, if this is the case check the AC fuse (see chapter 2.2.1). If the problem persists, please contact your service partner.
A permanent alarm signal resounds after connecting the device to the AC power supply.	The control unit's program memory has the wrong content. Please contact your service partner.
The menu to set the time appears every time the device is turned on.	The control unit's clock is powered by a battery (its regular life-span averages more than 5 years). The battery is empty and must be replaced. Please contact your service partner.

## 7. Maintenance

Functionality, reliability, and safety characteristics of the device are only guaranteed in case of proper use in accordance with the operating instructions. Safety control, maintenance work, repair work, and modifications shall be carried out only by the manufacturer or by authorized service agents authorized. In case of a failure, parts which influence the safety of the device may only be replaced by original spare parts of the manufacturer. The electric installation must correspond to the requirements in accordance with VDE/IEC. The device does not contain any parts which need maintenance work done by the user.

### 7.1 Safety Controls

#### 7.1.1 Statutory requirements and regulations

Performance of technical safety checks is not obligatory, but is recommended by the manufacturer.

#### NOTES

Pay attention to any national regulations at the place of installation/operation.

#### 7.1.2 Performance of safety checks

It is recommended to have the device checked by the manufacturer or by a authorized service agency at 24-months intervals.

The check shall consist of at least the following criteria:

- Electrical safety check in accordance with the test plan of the manufacturer
- Check of the device in respect of external integrity
- Check of all display and operating elements in respect of damages
- Check of all inscriptions in respect of legibility

### 7.2 Cleaning, Disinfection and care

For cleaning and disinfection of the device and its accessories there **should not be used any agents containing:** higher portions of **phenol derivatives, alcohol, compounds of chlorine or peracetic acid**. It is recommended to use disinfectants on aldehyde basis.

We recommend cleaning the device with a soft, damp cloth. For tenacious stains you may also apply mild detergent used for delicate plastic surfaces.

The device is not suited for heat sterilization or for sterilization with gases.

#### ATTENTION

Before cleaning or disinfection unplug the power supply out of the socket!

The device is suited for wiping disinfection. It has to be observed that no liquids enter the device. Under no circumstance the plug or socket should get wet. For cleaning or disinfection the device may not be sprayed.

#### Control Unit, Applicators

Do not immerse in water! Use normal household cleaners for synthetic materials. Only wipe with a damp cloth. Be sure to keep sharp, pointed objects away from mat applicator and pillow applicator. When using the coil mat and coil pillow, please make sure that no sharp objects are pressed in. Do not expose the system to direct sunlight and protect it from frost.

#### Placing Mat under a Mattress

The mat can be placed under a Mattress Pad, Mattress Protector, or woolen blanket that is placed against the mattress and or under the sheets of the bed....in order to avoid undesirable bacteria or fungi caused by sweat.



## 8. Contraindications and safety precautions

### A.) **Contraindications:**

There are NO Known Contraindications

### B.) **Precautions:**

In the case of severe health issues and the following list, you should always continue monitoring of your health by your healthcare practitioner. Also, medications usually need to be adjusted due to increased cellular regulation

- pregnancy
- epilepsy
- massive hypothyroidism
- very severe heart rhythm disturbances
- cancer
- severe hypo and hypertension

The PureWave PEMI application is unobjectionable for metal implantation or pacemakers which comply with the standards or EN 60601-2-31. In the case of patients with other implanted electronic EN devices, a risk assessment should be carried out, and if necessary, use the therapy under medical supervision.

- Cell phones should be turned off or placed at a one-meter distance from the device.
- If the person and/or applicator or its connecting cables are in the immediate sphere of a high frequency, short wave, or microwave therapy device,... the possible damage of the device or person may not be excluded. Please keep a distance of at least 3 m.
- The device is not intended to be used in areas with the risk of an explosion. If it is used in anesthesia rooms, in an endangered area, a possible explosion cannot be ruled out.

For all recognizable malfunctions, please contact your distributor or an authorized service partner.

### 8.1 Operating stuff security

The emitting magnetic field is distributed up to 0.3 m beyond the mat/pad applicator. Persons who are within the field of the magnetic therapy should stay beyond the stated range, unless they are purposely wanting the therapy session as well.

### 8.2 Application for babies and children

As infants and children sometimes respond more sensitively than adults, PEMI therapy should be started gradually with low intensities. Basically, there are no contraindications because therapy is performed well below the so-called geomagnetic earth radiation levels.

- For infants and older babies, you should only apply the field strength “sensitive“ with the pillow applicator.
- For children aged two to ten, the intensity setting medium should be selected as a maximum.

### 8.3 Further additional reactions in the application

In the case of possible allergic reactions, cover the applicator with biocompatible fabric or paper.

- If a person’s blood pressure increases, as may sometimes be observed at the beginning of a PEMI treatment, please reduce the intensity until the person has become accustomed to the PEMI treatment.
- In the case of possible feelings of vertigo, which may also occur at the beginning of treatment, please lower the intensity and/or reduce the application to once a day.
- In chronic illnesses initial aggravations may occur, as they are known from homeopathic medicines. The therapy should not be ended, though. Biological initial aggravations namely indicate the beginning reaction and/or loosening of blockades within the body.
- Possible second deterioration may occur once more after several weeks of PEMI application. If necessary, the length of application and the intensity should then be reduced and thereafter slowly increased again.

- Should a person be on medication, most often the medication may be reduced by the Doctor monitoring the person in that respect. People may need to work with their doctor to determine new medication levels needed, which can be reduced if directed by their Doctor.

## 8.4 Explanation of the signs used

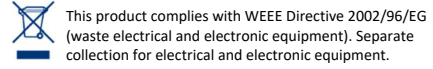
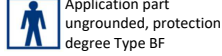
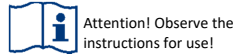

## 9. Technical data

AC voltage, frequency and power consumption	115/230 V, 50/60 Hz, 7 W	
Power consumption in stand-by mode	maximum 800 mW	
Fuse	1 A	
Output signal	As a maximum 3 V, 170 mA, 40 $\mu$ T	
Protection degree	BF	
Protection against ingress of water	IPX0	
Dimensions, Weight	40 mm x 190 mm x 215 mm (h x w x d), 0,688 kg	
Display	Dot-matrix, 16 characters	
Environmental conditions	Operation of the device:	Temperature range +10 °C up to +40 °C Relative humidity 30 up to 75 %
	Transport and storage:	Temperature range +5 °C up to +50 °C Relative humidity < 90 %, none condensing

PureWave reserves the right to modify the design and specification without prior notice.

## 10. Index

<b>A</b>		<b>O</b>	
Applicator	5, 7, 8, 9, 17, 18, 19, 20, 21, 23, 24, 25,	On/off	6, 7, 8, 10, 11, 12, 13, 15, 18, 19
Applicator jack	26, 27		
	9, 17		
<b>B</b>		<b>P</b>	
Baby		Pain	5, 13, 22
Backlight	26	Program	5, 6, 7, 14, 15, 16, 18, 19, 20, 21, 22, 24
Basic function	6, 10		
	9		
<b>C</b>		<b>R</b>	
Child		Restore	14, 18
Chip card	26		
Cleaning	5, 7, 9, 15, 17, 23, 24		
Coil mat	25		
Coil pillow	21, 25		
Connecting	20, 25		
Contraindications	8, 24, 26		
Controls	26		
	25		
<b>D</b>		<b>S</b>	
Date		Safety	25, 26, 27
Disinfection	12, 13	Speaker	6, 11, 14
Display	25	Stability	5, 6, 15, 16, 22
	6, 7, 8, 9, 10, 11, 12, 13, 14, 15, 16, 17,		
	18, 19, 23, 24, 25, 27		
<b>E</b>		<b>T</b>	
Error	7, 8, 11, 23, 24	Technical data	27
		Therapy	5, 6, 7, 8, 9, 11, 14, 15, 16, 17, 18, 19, 20,
			21, 22, 23, 24, 26
		Time	5, 6, 8, 9, 12, 13, 15, 16, 17, 21, 26
		Timer	7, 14, 18, 19, 24
		Tranquility	5, 14, 15, 16, 22
		Troubleshooting	8, 23
		Turning on	8
		<b>V</b>	
		Vitality	5, 15, 16, 22
		<b>W</b>	
		weather changes	22
<b>F</b>			
Finetuning			
Frequency	16		
Function test	5, 7, 20, 22, 26, 27		
Fuse	8		
	7, 24, 27		
<b>I</b>			
Intensity			
	5, 6, 14, 15, 16, 18, 19, 20, 21, 22, 26		
<b>L</b>			
Language			
	13, 14		
<b>M</b>			
Magnetic field			
Modes	5, 20, 21, 22, 26		
	5, 6, 7, 8, 9, 10, 11, 12, 13, 14, 15, 16, 17,		
	18, 19, 20, 21, 22, 23, 24, 25, 26		



1014 Gateway Blvd | Boynton Beach | Florida 33426  
phone: 561-342-1999 | email: [info@purewavelife.com](mailto:info@purewavelife.com) | web: [purewavelife.com](http://purewavelife.com)